

## PROTECTION AGAINST BOILER CORROSION AND FOULING

### Load Valves with automatic by-pass balancing



#### TSV3B

#### Valves for return temperature control, with automatic by-pass balancing

TSV B load valves mix cool return water from a heating system or thermal store with hot water from a boiler flow, **keeping boiler return water** (i.e. its heat transfer surfaces) at a temperature that will **not allow condensation to occur**. The boiler then works with higher efficiency and its service life is extended.

The valves feature automatic by-pass balancing. The exact control prevents boiler overheating and keeps a steady flow rate through a boiler under any temperature if the system is properly designed. When restricting the flow through one port, it opens the other one simultaneously.

#### Dimensions

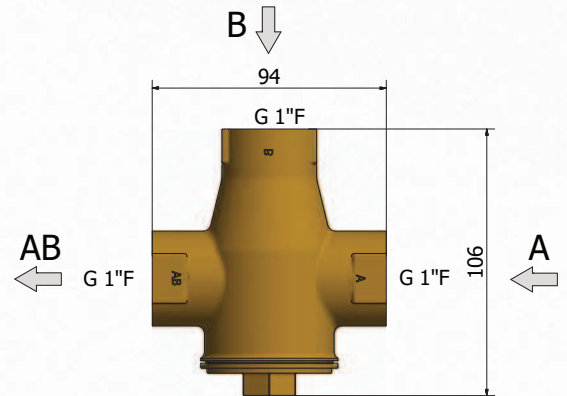

#### Versions

|                       |                   | TSV3B 45 | TSV3B 50 | TSV3B 55 | TSV3B 60 | TSV3B 65 | TSV3B 70 |
|-----------------------|-------------------|----------|----------|----------|----------|----------|----------|
| OPENING TEMPERATURE   | °C                | 45       | 50       | 55       | 60       | 65       | 70       |
| NOMINAL DIAMETER      | -                 | DN25     | DN25     | DN25     | DN25     | DN25     | DN25     |
| CONNECTION SIZE       | --                | G 1" F   | G 1" F   | G 1" F   | G 1" F   | G 1" F   | G 1" F   |
| $K_{vs}$ from A to AB | m <sup>3</sup> /h | 6.2      | 6.2      | 6.2      | 6.2      | 6.2      | 6.2      |
| $K_{vs}$ from B to AB | m <sup>3</sup> /h | 4.4      | 4.4      | 4.4      | 4.4      | 4.4      | 4.4      |
| WEIGHT                | kg                | 0.77     | 0.77     | 0.77     | 0.77     | 0.77     | 0.77     |
| CODE                  | --                | 11 282   | 15 517   | 11 281   | 15 518   | 10 080   | 15 519   |

#### Connection in a system

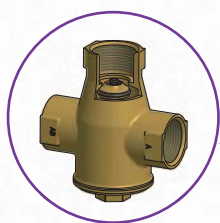

TSVB valve with automatic by-pass balancing

